

Preload Adjustment Crankset Installation Instructions

Published – Dec, 2023. ZS225.v1 © Full Speed Ahead

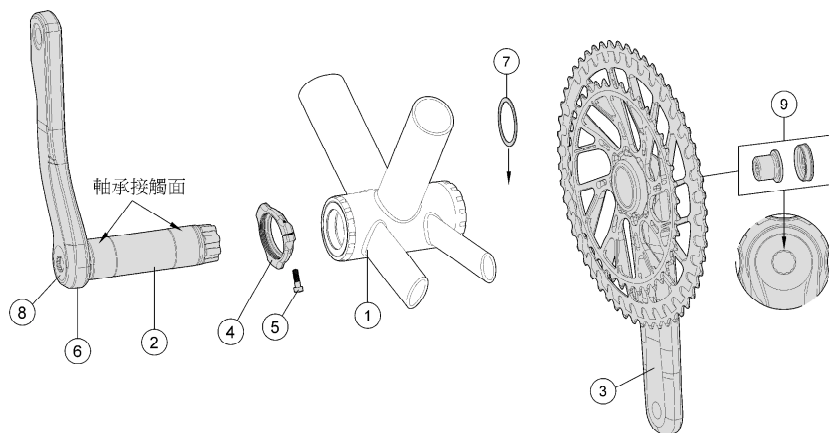

Crankset Installation

1. Ensure the Bottom Bracket Shell ① is BB386EVO compatible. (Note : Follow the BB installation instruction for BB will be installed).

2. Lightly grease the spindle bearing contact surface ② and insert from non-drive side.

⚠ CAUTION Take care the spindle ② does not damage plastic bearing covers during installation.

3. Install the Right Crank Arm ③ onto the Spindle. Use 8mm hex wrench to tighten the QR Self Extracting Crank Bolt ⑨ to 388-418 kgf.cm / 38-41 Nm / 336-363 in.lbs. Do not tighten crank bolt over 418 kgf.cm / 41 Nm / 363 in.lbs.

4. Adjust preload nut ④ until crank contact BB assembly. Tighten preload nut set screw ⑤ with 2.5mm allen to a torque 26-36 kgf.cm / 2.5-3.5 Nm / 22-31 in.lbs to secure preload nut.

⚠ CAUTION Ensure correct torque is used. The 0.5mm spacer ⑦ may be used only to adjust CL to ensure shifting performance.

⚠ CAUTION Do not remove Left arm crank bolt ⑧ unless removal of left arm is necessary. For left arm removal, see below instructions. For service always use 8mm hex wrench to remove the Right Crank Arm ③.

Left Arm Removal in case of need to change spindle

1. Use a 8mm hex wrench to remove drive arm ③ with the self extracting bolt ⑨.

2. Remove drive side (right) crank arm ③ self extracting collar ⑨ using a 10mm Hex.

3. Remove the left side crank bolt ⑧ using a 10mm hex wrench.

4. Install the self extracting bolt and self extracting collar ⑨ in to the left crank arm ⑥. Ensure the self extracting collar is in completely tightened.

5. Loosen the self extracting bolt to remove left arm.

⚠ CAUTION Apply threadlocker (Loctite 242 or equivalent) on the Crank bolt ⑧ at least 6 threads for new spindle installation. Use and allow to cure according to threadlocker instructions. Check the Spindle dimension is correct. Refer to Fig. 1 before proceeding next installations.

⚠ WARNING Always use a calibrated torque wrench to tighten crank bolt ⑧ and ⑨. Check bolt torque 388-418 kgf.cm / 38-41 Nm / 336-363 in.lbs before each ride to ensure they have not loosened during use.

Introduction

Congratulations on your Full Speed Ahead product. Please read these instructions and follow them for correct use. Failure to follow the warnings and instructions could result in damage to product not covered under warranty, damage to bicycle; or cause an accident resulting in injury or death. Since specific tools and experience are necessary for proper installation, it is recommended that the product be installed by a qualified bicycle technician. FSA & Vision assumes no responsibility for damages or injury related to improperly installed components.

Warranty

Full Speed Ahead (FSA) warrants all FSA and Vision products to be free from defects in materials or workmanship for a period of two years after original purchase unless otherwise stated in the full warranty policy. The warranty is non-transferable and valid to the original purchaser of the product only. Any attempt to modify the product in any way such as drilling, grinding, and painting will void the warranty. For more information on warranty policy and instructions for completing a warranty claim, check out the Full Warranty Policy found at our website: <https://www.fullspeedahead.com/en/technology>

Specification

Model Name K-Force Team Edition Direct Mount 2X BB386EVO
K-Force Team Edition Direct Mount 1X BB386EVO
SL-K Light Direct Mount 2X BB386EVO

Components

Follow the assembly order in the illustration:

- | | |
|--|--------------------------------|
| ① Bottom Bracket Shell x1 | ⑦ 0.5 mm Spacer x1 |
| ② Crank Spindle x1 (Pre-installed on Left Crank) | (not included in crankset) |
| ③ Right Crank Arm x1 | ⑧ Crank bolt x1 |
| ④ Preload Nut x1 | (Pre-installed on Left Crank) |
| ⑤ Preload Nut Set Screw x1 | ⑨ QR Self Ext. Crank Bolt x1 |
| ⑥ Left Crank Arm x1 | (Pre-installed on Right Crank) |

Fig.1 Spindle dimension (w/o Preload Nut ④)

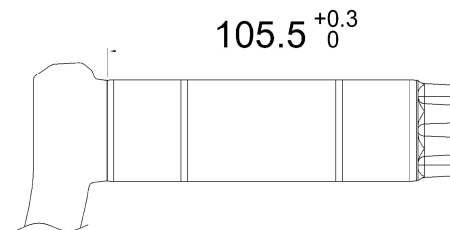

Contact

If you have questions, please visit our web site technical section: <https://www.fullspeedahead.com/en/support> or contact:

Full Speed Ahead, USA
12212 Cyrus Way Mukilteo, WA 98275-5702
Tel: 1_425_488_8653 Fax: 1_425_489_1082

Full Speed Ahead, Europe
Via Del Lavoro, 56 20874 Busnago, Milan, Italy
Tel: +39_039_688_5265 Fax: +39_039_682_3336

TH INDUSTRIES / FSA Asia
NO.6, Wu-gong 8th Rd., Wufeng Dist., Taichung City 41353, Taiwan (R.O.C.)
Tel: +886_4_2331_9134 Fax: +886_4_2331_9314