

BB30 Bearing Installation and Removal Installation Instructions (Shop Version)

Published – Mar, 2011. ZS071A.v3 © Full Speed Ahead

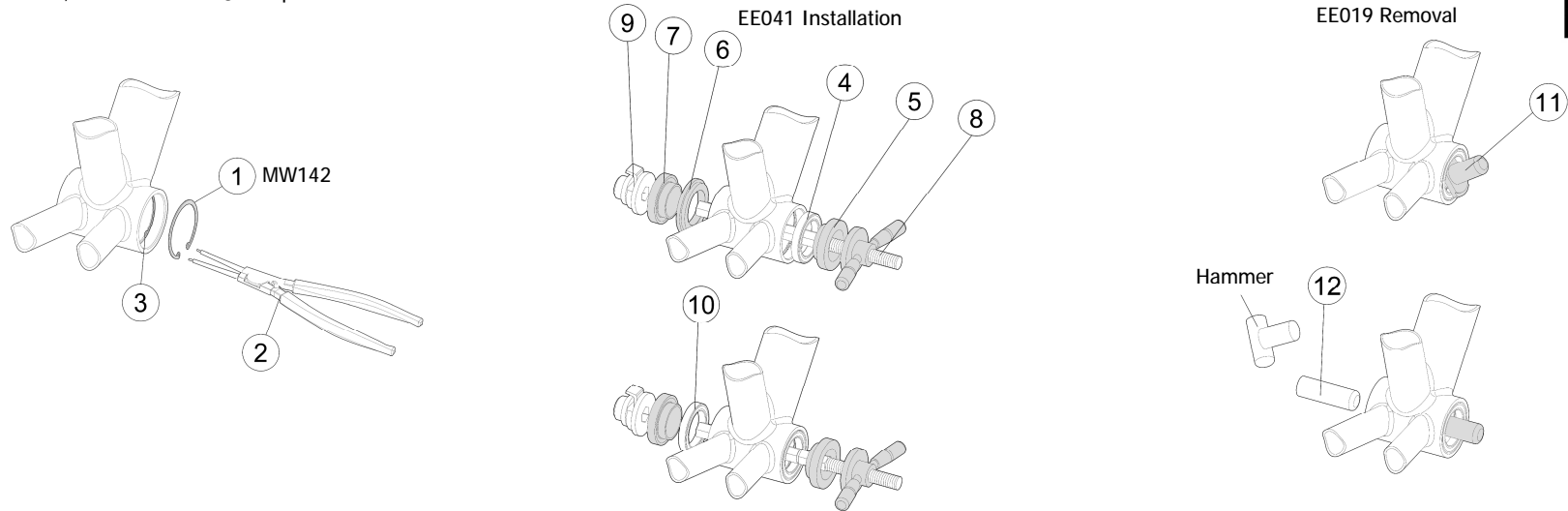

Introduction

Congratulations on your Full Speed Ahead product. Please read these instructions and follow them for correct use. Failure to follow the warnings and instructions could result in damage to product not covered under warranty, damage to bicycle; or cause an accident resulting in injury or death. Since specific tools and experience are necessary for proper installation, it is recommended that the product be installed by a qualified bicycle technician. FSA & Vision assumes no responsibility for damages or injury related to improperly installed components.

Warranty

Full Speed Ahead (FSA) warrants all FSA, Gravity, Vision, Metropolis and RPM products to be free from defects in materials or workmanship for a period of two years after original purchase unless otherwise stated in the full warranty policy. The warranty is non-transferable and valid to the original purchaser of the product only. Any attempt to modify the product in any way such as drilling, grinding, and painting will void the warranty. For more information on warranty policy and instructions for completing a warranty claim, check out the Full Warranty Policy found at our website: <http://www.fullspeedahead.com/techdoc>

Specification

Item Number / Model Name EE041 / BB30 Bearing Installation Tool

Item Number / Model Name E0019 / BB30 Bearing Removal Tool

Components

Follow the assembly order in the illustration:

- | | |
|--|--------------------------------------|
| ① Collapse circlip | ⑧ ⑨ Headset press |
| ② Circlip plier | ⑩ Install opposite side bearing |
| ③ Circlip groove in BB shell | ⑪ BB30 bearing removal tool (#E0019) |
| ④ Bearing | ⑫ Driver |
| ⑤ ⑥ ⑦ FSA bearing installation tool (#EE041) | |

BB30 Inspection

I Verify the frame specification is compatible with the BB30 system.

⚠ CAUTION Do not attempt to modify BB30 crankset or bottom bracket to fit into non-BB30 framesets. Attempting to install BB30 cranksets and bottom brackets into non-compatible frames will result in damage to crankset, bottom bracket, and bicycle frame.

I Ensure that bottom bracket (BB) shell is clean and free of metal chips, dirt, and excess paint.

BB30 Installation

1. Tools:

- A. Grease
- B. Circlip pliers
- C. FSA BB30 bearing installation tool (#EE041)
- D. Headset press
- E. 32mm wrench

2. Preparation:

- A. Ensure that bottom bracket (BB) shell is clean and free of metal chips, dirt, and excess paint.
- B. Apply a thin layer of grease to the inside surface of the bottom bracket shell.

3. BB Shell Circlips:

- A. Apply a thin layer of grease to the BB circlip groove ③.
- B. Using a circlip plier ②, collapse circlip ① and insert into machined circlip groove in BB shell ③.
- C. Ensure circlip is fully seated in groove.

⚠ WARNING Wear eye protection. Circlips may have sharp edges and can cause serious eye injury by springing from BB or tool while installing.

4. Installation of Bearings with FSA BB30 Bearing Installation Tool:

- A. Apply a thin layer of grease to outer bearing ④ surfaces.
- B. Using FSA bearing installation tool (#EE041) ⑤ on a headset press ⑥ ⑨, install one bearing by using tool ⑥ ⑦. Press bearing into BB shell until it is butted against the circlip.

⚠ WARNING The BB30 bearings must press in straight. If the installation of the bearings is angled, damage may occur.

- C. Install opposite side bearing ⑩ by using tool. Press bearing into BB shell until it is butted against the circlip.
- D. Place alloy bearing shields over bearings with machined grooves facing inward, toward the bearings.

BB30 Removal

1. Tools:

- A. 10mm allen tool
- B. FSA BB30 bearing removal tool (#E0019)
- C. Punch or driver
- D. Small hammer
- E. 6mm allen tool
- F. Circlip pliers

2. Preparation:

- A. Using 10mm Allen tool, extract left crank arm from the spindle with self extracting crank bolt.
- B. Remove crankarms and spindle from the BB.

3. Removing Bearings with FSA BB30 Bearing Removal Tool:

- A. Tilt FSA BB30 bearing removal tool (#E0019) ⑪ inward and position on the inside face of the bearing.
- B. Locate a driver ⑫ on the opposite side of the tool. Using a small hammer, lightly tap the driver until bearing is removed from the BB shell.
- C. Repeat from other side.

4. Removing Circlip:

- A. Removal is reverse of installation. This is an unnecessary step for bearing replacement.

**Contact**

If you have questions, please visit our web site technical section: <http://www.fullspeedahead.com/contact> or contact:

Full Speed Ahead, USA
12212 Cyrus Way Mukilteo, WA 98275-5702
Tel: 1_425_488_8653 Fax: 1_425_489_1082

Full Speed Ahead, Europe
Via Del Lavoro, 56 20874 Busnago, Milan, Italy
Tel: +39_039_688_5265 Fax: +39_039_682_3336

TH INDUSTRIES / FSA Asia
NO.6, Wu-gong 8th Rd., Wufeng Dist., Taichung City 41353, Taiwan (R.O.C.)
Tel: +886_4_2331_9134 Fax: +886_4_2331_9314

Notes: Specifications of product may be changed or improved for performance. Please refer to website periodically for technical updates and revised instructions. Printed in Taiwan.

