

PF30 Press Fit Bottom Bracket Installation Instructions

Published – Jul, 2021. ZS126.v5 © Full Speed Ahead

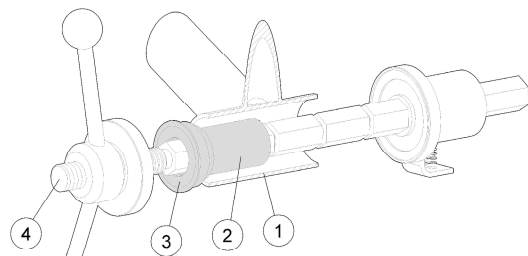

Fig. 1

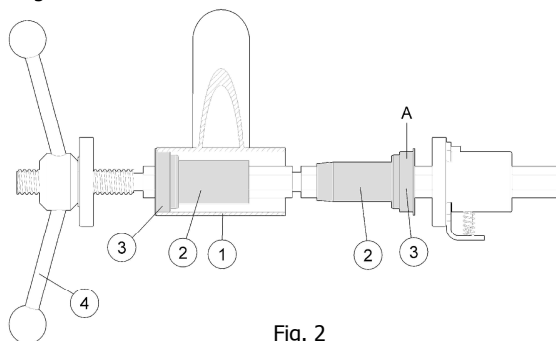

Fig. 2

Introduction

Congratulations on your Full Speed Ahead product. Please read these instructions and follow them for correct use. Failure to follow the warnings and instructions could result in damage to product not covered under warranty, damage to bicycle; or cause an accident resulting in injury or death. Since specific tools and experience are necessary for proper installation, it is recommended that the product be installed by a qualified bicycle technician. FSA & Vision assumes no responsibility for damages or injury related to improperly installed components.

Warranty

Full Speed Ahead (FSA) warrants all FSA, Vision and RPM products to be free from defects in materials or workmanship for a period of two years after original purchase unless otherwise stated in the full warranty policy. The warranty is non-transferable and valid to the original purchaser of the product only. Any attempt to modify the product in any way such as drilling, grinding, and painting will void the warranty. For more information on warranty policy and instructions for completing a warranty claim, check out the Full Warranty Policy found at our website: <https://www.fullspeedahead.com/en/technology>

Specification:

Model Name / Item Number **BB-PF8200 & BB-PF6000**

Model Name / Item Number **BB-PF30A/73/SMN**

Components

Follow the assembly order in the illustration:

- ① Bottom Bracket Shell
- ② Plastic Center Sleeve x1
- ③ Bearing Cup x2
- ④ Headset Press Tool (not included)

Press Fit Bottom Bracket Installation

This Section refers to installing the FSA Pressfit 30 (PF30) bottom bracket into a PF30 compatible frame.

BB-PF30A/73/SMN is for Cannondale PRESS FIT 30A Asymmetric bottom bracket shells width 73mm only.

Press Fit Bottom Bracket Installation

1. Ensure that Bottom Bracket (BB) shell ① is clean and free of metal chips, dirt, and excess paint.
2. Install only one bearing cup in the BB shell at a time to avoid damage to the plastic center sleeve ②.
3. Place Bearing cup ③ with plastic sleeve ② on the press tool ④ (Fig. 1).
Note: Drive and non-drive side bearing cups are the same for BB-PF8200 & BB-PF6000. BB-PF30A/73/SMN bearing cups are different and indicated with " DS B3234 " and " NDS B3233 ".
4. Slide the Press tool ④ through the Bottom bracket Shell ①.
5. Using the Press tool ④ press the bearing cup ③ with half sleeve ② into the BB shell. Tighten until the thrust face of the Bearing Cup ③ is flush with the outer face of the Bottom Bracket shell ①.
6. Repeat steps 4 through 6 to install remaining bearing cup with sleeve. Be certain that the center sleeve halves are aligned properly to avoid damage. One side of the center sleeve should easily fit over the other (Fig. 2).
Note: Be certain that the bearing cups and tool faces are aligned and square otherwise damage to the plastic covers and bottom bracket shell may occur.
7. When Bottom Bracket is completely installed, unscrew Press tool and carefully remove from the Bottom bracket.
8. Check bearings for rotational smoothness. If bearings feel rough, it may be an indication the cups are not perfectly aligned in the bottom bracket shell. It may be necessary to carefully remove and reinstall the bearings to be assured bearing alignment in the bottom bracket shell.
Note: The plastic cups used for PF30 may be damaged if removed after installation. If damage occurs the cups should be replaced.
Note: Ensure bottom bracket and crankset compatibility before crankset installation. Cranksets should be installed per cranksets manufacturer's instructions.

Contact

If you have questions, please visit our web site technical section: <https://www.fullspeedahead.com/en/support> or contact:

Full Speed Ahead, USA
12212 Cyrus Way Mukilteo, WA 98275-5702
Tel: 1_425_488_8653 Fax: 1_425_489_1082

Full Speed Ahead, Europe
Via Del Lavoro, 56 20874 Busnago, Milan, Italy
Tel: +39_039_688_5265 Fax: +39_039_682_3336

TH INDUSTRIES / FSA Asia
NO.6, Wu-gong 8th Rd., Wufeng Dist., Taichung City 41353, Taiwan (R.O.C.)
Tel: +886_4_2331_9134 Fax: +886_4_2331_9314